

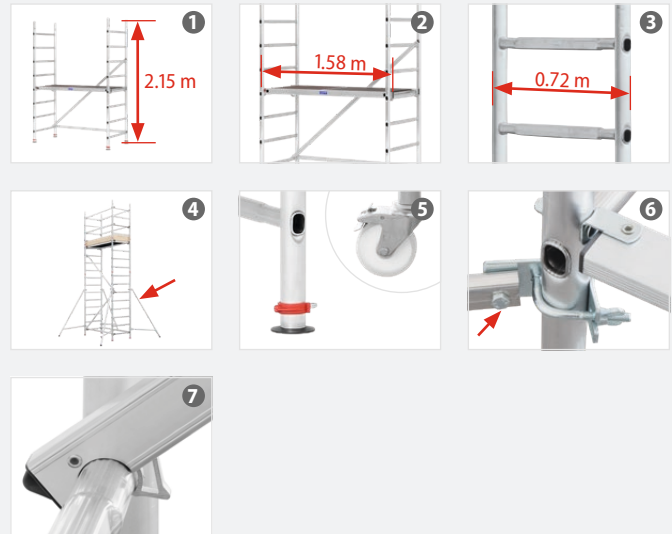

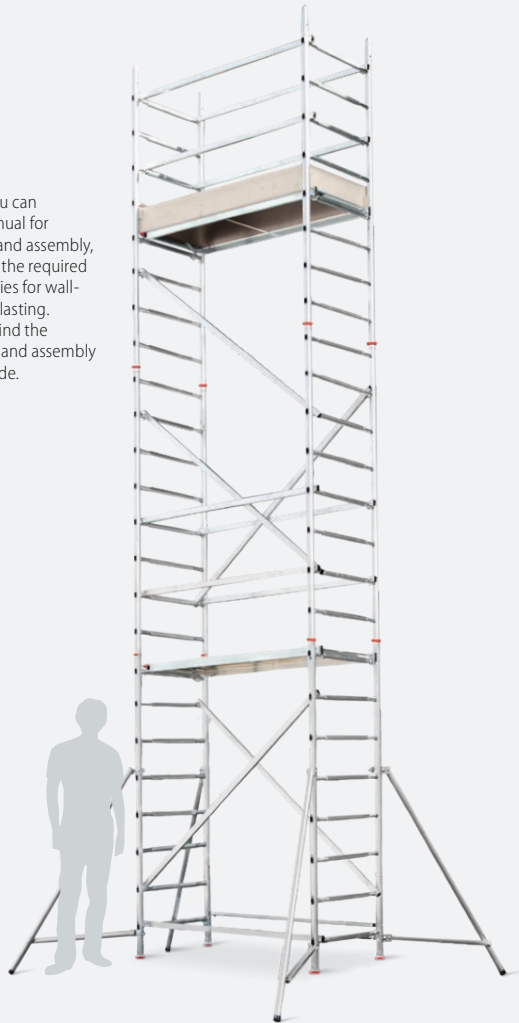



70094 Modular tower AL 700

With each tower you can find enclosed a manual for instructions of use and assembly, where you can find the required amount of accessories for wall-connection and ballasting. Moreover you can find the instructions for use and assembly at www.hymer-alu.de.



- 1 **Light, flexible tower** with compact storage and transport measures.
- 2 Spacious through **1.58 m long platform**.
- 3 **Large working surface** through 0.72 m tower width.
- 4 From 4.95 m reach height on **with stabiliser** for high stability.
- 5 As well usable as mobile tower: equipped with disc feet, **castor as accessory available**.
- 6 **Tools only necessary for initial assembly** of the stabiliser and wall connector.
- 7 **Quick assembly and dismantling** through quick-release catches on braces.

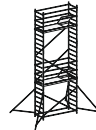

						
Module and assembling combinations		Module 1	Module 2	Module 3	Module 1+2	Module 1+2+3
Frame section	approx. m	0.72	0.72	0.72	0.72	0.72
Platform length	approx. m	1.58	1.58	1.58	1.58	1.58
Reach height	approx. m	2.95	–	–	4.95	6.95
Tower height	approx. m	2.15	–	–	4.15	6.15
Standing height	approx. m	0.95	–	–	2.95	4.95
Weight	approx. kg	18.8	29.4	23.8	48.2	72.0
Permissible load		200 kg/m ² (2.0 kN/m ²), tower group 3				
EAN code		4019502325333	4019502325340	4019502325357	4019502357235	4019502357228
Order no.		7009403	7009415	7009417	7009405	7009407